



# Lumra<sup>TM</sup> Navigation Camera

## Discover how AI enhances your confidence on or off the water

### Power and Simplicity

The STRAVION Navigation Camera uses the power of advanced imaging to help you see hazards that are typically hidden. Unlike thermal imaging, IR night vision technology helps you pinpoint potential threats that are the same temperature as the environment, and with built-in illumination you will never miss an important moment.

Experience integrated AI via the mobile app so you can identify and track hazards in real-time. With the addition of a video-over-ethernet connection to your MFD, so you can build the navigation setup that's most compatible with your vessel or vehicle while still enjoying mobile video and command & control via WiFi.

- Integrated AI via iOS/Android app
- Stream, record and store over WiFi via mobile device
- Identify & track hazards in real-time
- Easy installation with minimal wiring
- 2x or 4x digital zoom



### Crystal Clear Navigation

Lumra's 4K CMOS sensor and IR illumination deliver crystal clear navigation in any lighting. Its high resolution and wide dynamic range make it essential for land and sea navigation.



### Artificial Intelligence

Advanced AI detection eliminates guesswork by instantly identifying, classifying, and tracking potential hazards in real-time.



### Anywhere, Any Weather

Small, rugged and capable, Lumra is ready to help navigate any terrain or waterway in any weather.



For more, visit us  
at [stravion.io](https://stravion.io)

**STRAVION**<sup>TM</sup>  
Beyond the visible.<sup>TM</sup>

Lumra™ Navigation Camera



Camera

	CV4G / CV4B	CV3G / CV3B
Sensor Type	4K Color CMOS sensor	4K Color CMOS sensor
Resolution	3840x2160 [8.5Mpix]	3840x2160 [8.5Mpix]
Horizontal FOV	27	43
Wavelength Range	400-1000 nm	400-1000 nm
Focus Range	3M (9 ft) to Infinity	3M (9 ft) to Infinity
Lens	12mm F-2	8mm F-2
Shutter Type	Rolling	Rolling
IR Cut Filter	Mechanical IRC	Mechanical IRC

System

Image Encoding	JPG	JPG
Video Encoding	H264/ H265/ MJPG	H264/ H265/ MJPG
Video Out	Ethernet / WiFi	Ethernet / WiFi
Video Stream Protocols	RTSP, ONVIF, WebRTC	RTSP, ONVIF, WebRTC
IR Illumination	850nm	850nm
IR Illumination FoV	30	30
IR Illumination Max Power	15W [PWM]	15W [PWM]

Communcation

Wired Network	10/100	10/100
Wireless Network	802.11b/g/n/ac	802.11b/g/n/ac
Wireless Range	10m (33')	10m (33')
WiFi Security	WPA2	WPA2
Network Protocol	RTSP, ONVIF-S, HTTP, TCP, UDP, TFTP, TELNET	RTSP, ONVIF-S, HTTP, TCP, UDP, TFTP, TELNET

Power

Voltage Input Range [Vdc]	12-24Vdc	12-24Vdc
Max Input Current [Adc]	2A	2A
Power Input Range [Watts]	5W - 20W	5W - 20W
Power Connection Type	Tinned Copper Wire	Tinned Copper Wire

Environmental

	CV4G / CV4B	CV3G / CV3B
Ingress Protection	IP67 / IK07	IP67 / IK07
EMC	IEC60945	IEC60945
Operating Temperature	-20 to +50 °c (-4 to 122°f)	-20 to +50c (-4 to 122 f)
Storage Temperature	-40 to +60 °c (-40 to 140°f)	-40 to +60 °c (-40 to 140°f)

Camera  
[Physical]

Weight	350g (0.8Lbs)	350g (0.8Lbs)
Dimensions	68 x 68 x 95mm (2.68 x 2.68 x 3.74 in)	68 x 68 x 95mm (2.68 x 2.68 x 3.74 in)
Mounting Options	1/4 x 20 Bottom Mount / VESA 4-Point 50 mm Mount	1/4 x 20 Bottom Mount / VESA 4-Point 50 mm Mount
Material	UV Stabilized ABS/PC Blend   Machined Aircraft Aluminum	UV Stabilized ABS/PC Blend   Machined Aircraft Aluminum
Dimensions (Mount)	70x75x75mm (2.75"x3"x3")	70x75x75mm (2.75"x3"x3")
Material (Mount)	Machined Aluminum	Machined Aluminum

Other Features

Image Orientation Control	Flip / Mirror   Rotate	Flip / Mirror   Rotate
Digital Zoom	2X or 4X	2X or 4X
Electronic Image Stabilization	6-axis IMU	6-axis IMU
Day / Night Modes	Automatic / Manual / OFF	Automatic / Manual / OFF
Digital Dynamic Range	WDR / HDR	WDR / HDR
Digital Noise Reduction [DNR]	Yes	Yes

Mobile App

Operating Systems	Android / iOS	Android / iOS
Video Analytics	AI-based Analytics	AI-based Analytics
Video Recording	Local Storage	Local Storage

Camera

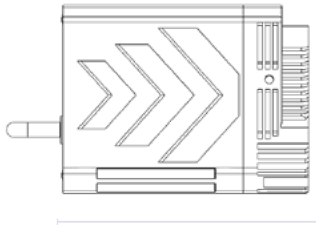
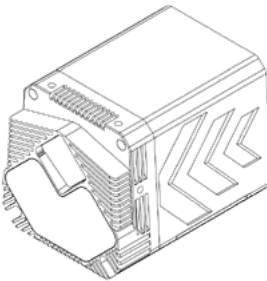
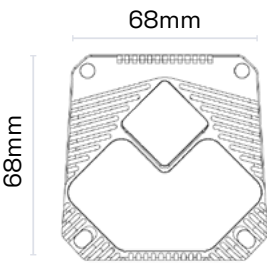

Mount

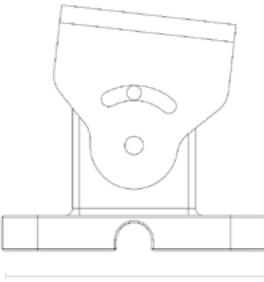
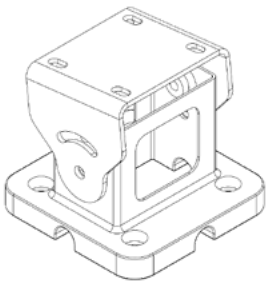
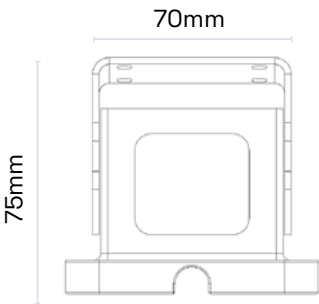

Mechanical Line Art

# Beyond the visible.™



Tom Frane  
Executive VP  
tom.frane@stravion.io  
+1 (503) 701-0213

Gio Lepore  
Head of Product  
gio.lepore@stravion.io  
+1 (781) 789-8228

4422 Airport Expressway, Suite 220  
Fort Wayne, IN 46809  
United States



Visit us at [stravion.io](https://stravion.io) to learn how you can [harness the power of AI](#) [integrated with advanced day & night vision technology](#) powered by the next generation of intelligent vision systems.

## STRAVION™

